



# SLIM-HANDTRONIX no touch

## STAND ALONE UNIT FOR THE MANAGEMENT OF SINGLE DOORS

### Export Product-list

January 2018



**TECNODIMENSIONE®**

Ordering information



Q.ty

### Models for 12 Vdc power supply

MODELS

N°

#### Assembly type 1

fully aligned concealed for recess-mounting without flange on the same plane of the door frame panel \*

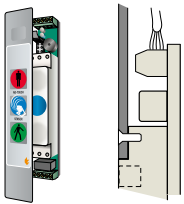

SLIM-HANDTRONIX stand alone unit type 1 with fully aligned concealed for recess-mounting on the same plane of the door frame panel without flange.

Ideal to achieve a "smooth" surface (without roughness) that is easy to clean.

Supplied with diffuser screen and gap G for sections with a thickness of 1.6 mm.

Fitted (instead of the manual push button) with an infrared sensor that "sees" a presence up to 10 cm away. Basically, the "contactless" door opening and/or doorbell command is automatically triggered by bringing the hand close to the unit, without actually touching it. Complete with self-adhesive cover designed to be applied after the final installation of the system.

**\* In this case it is advisable to prepare the recess during the door frame machining.**

034991HM

Same with front panel and gap G for sections with a thickness of 3 mm

034991HM3

#### Assembly type 2

fully aligned at milling for recess-mounting with front flange on the same plane of the panel surface ◆

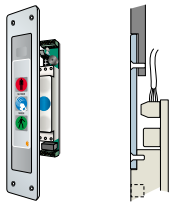

SLIM-HANDTRONIX stand alone unit type 2 for aligned recessed flush fitting in bottom of panel using front flange (e.g. To mount on wall panel next to the door frame on the post where no chasing can be carried out). Fitted (instead of the manual push button) with an infrared sensor that "sees" a presence up to 10 cm away. Basically, the "contactless" door opening and/or doorbell command is automatically triggered by bringing the hand close to the unit, without actually touching it. Supplied with front flange in anodized aluminium with "silver" finish - 250 x 50 mm, thickness 2.5 mm for recess-mounting on the same plane of the panel surface for aligned recessed flush fitting in bottom of plane using front flange. Cover pre-assembled and fixed into the flange niche.

**◆ In this case, it is advisable to prepare sunk milling during the panel machining phase.**

034992HM

#### Assembly type 3

for conventional flush mounting with front flange overlapping door frame

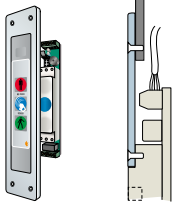

SLIM-HANDTRONIX stand alone unit, type 3 for traditional recessed fitting using flange.

Supplied with front flange in anodized aluminium with "silver" finish - 250 x 50mm, thickness 4 mm for flush mounting.

Fitted (instead of the manual push button) with an infrared sensor that "sees" a presence up to 10 cm away.

Basically, the "contactless" door opening and/or doorbell command is automatically triggered by bringing the hand close to the unit, without actually touching it.

Cover pre-assembled and fixed into the flange niche.

**Mounting can be carried out "on site", directly onto the installed door frame.**

034993HM

#### Assembly type 4

for surface mounting with using housing

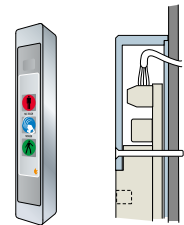

SLIM-HANDTRONIX stand alone unit type 4 for mounting placed on surface using housing. With extra-strong protective housing, made in anodized silver finish aluminium (35 x 25 x 215 mm).

Fitted (instead of the manual push button) with an infrared sensor that "sees" a presence up to 10 cm away.

Basically, the "contactless" door opening and/or doorbell command is automatically triggered by bringing the hand close to the unit, without actually touching it.

Self-adhesive cover in polycarbonate, provided separately and designed to be used as final cover to hide the 4 fixing screws of the housing on the door frame.

**Useful when you wish to avoid recess-mounting or cuts on the door frame.**

034994HM

#### Assembly type 5

for recessed wall-mounting with flange and wall-mounting receptacle

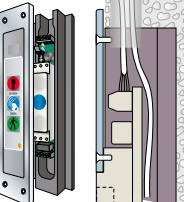

SLIM-HANDTRONIX stand alone unit type 5 for recessed assembly using flange and wall box. Supplied with front flange in anodized aluminium with "silver" finish - 250 x 50 mm, thickness 4 mm, to be fixed to the housing by placing on wall surface.

Self-adhesive cover in polycarbonate pre-assembled and fixed into the flange niche.

Fitted (instead of the manual push button) with an infrared sensor that "sees" a presence up to 10 cm away.

Basically, the "contactless" door opening and/or doorbell command is automatically triggered by bringing the hand close to the unit, without actually touching it.

Also fitted with wall box with "wings" for rapid anchoring (65 x 30 x 230 mm), in plastic taken from single block to be assembled "in a niche" in the wall to house the body of the standalone unit.

**Wall niche and cable channel to be prepared beforehand.**

034995HM

**Special configurations available at extra charge:** Cover with your logo and/or customized.

*For sizes, measurements and details of chasing, application examples and connection diagrams, see page 73*

# SLIM-HANDTRONIX STANDALONE UNIT - sizes, application examples and connection diagram

## Assembly type 1 total alignment, lock recessed into surface without flange

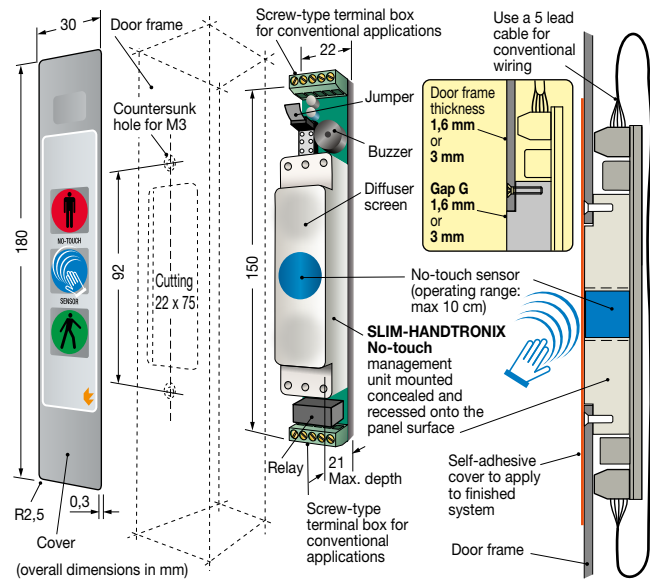

## Assembly type 2 alignment at bottom with front flange "flush with surface" at bottom

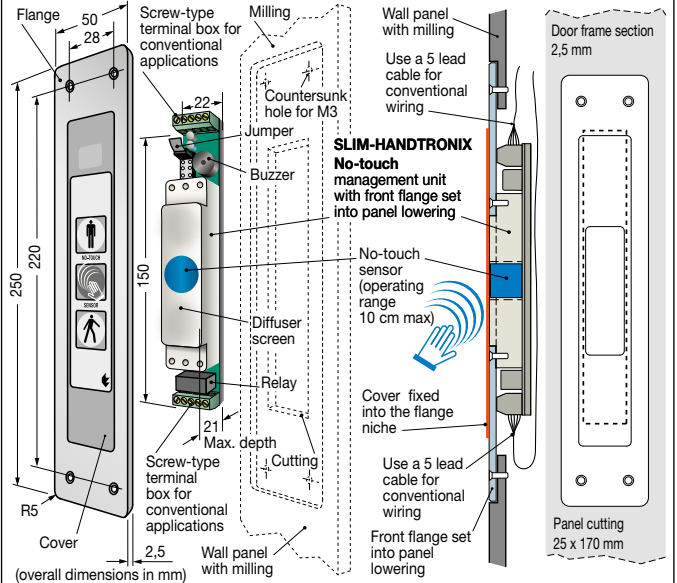

## Assembly type 3 traditional fitting with front flange over the lock

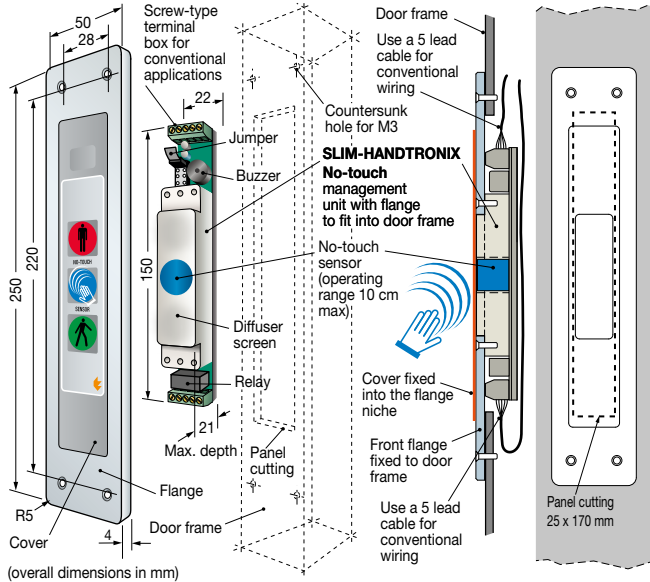

## Assembly type 4 for mounting placed on surface using housing

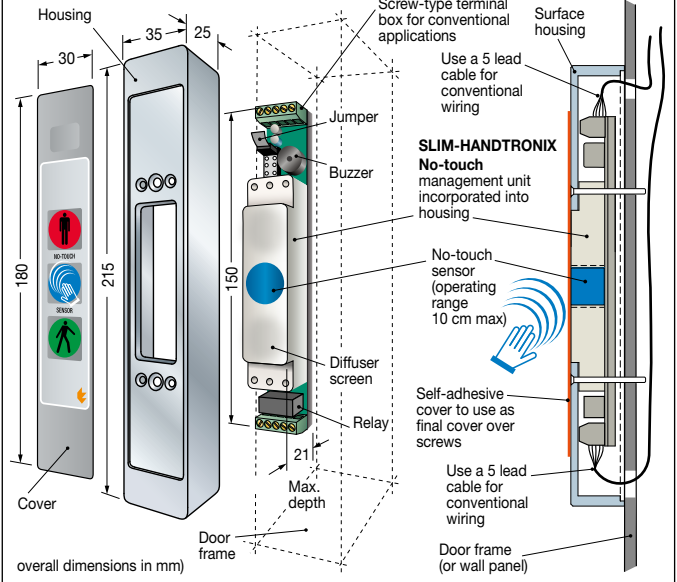

## Assembly type 5 for recessed wall mounting with flange and wall box

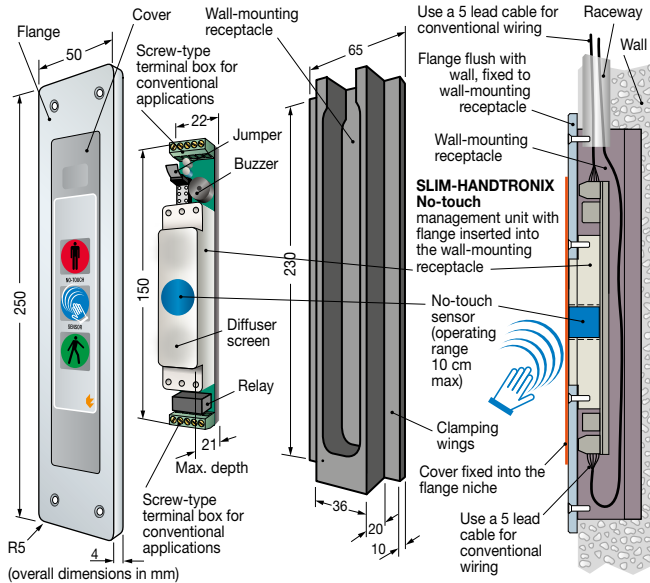

## CONNECTION DIAGRAM valid for all 5 types

