



SLIM-DUALUX No-touch

PROFESSIONAL SENSORIZED STOP/GO DISPLAYS

With quick fitting PLUG RJ45 - 8 poli for a more practical installation and immediate cable routing

Export Product-list
January 2018



- With 2 8-pole quick fitting RJ45-8 connecting plugs + 1 dummy load (end of line adapter).
- Green/red light + buzzer.
- Equipped (instead of manual pressure button) with an infrared sensor that "sees" a presence up to 10 cm away. The "contactless" door-opening command and/or alarm works automatically by bringing the hand close, **without touching anything**.

- Timed command with exit relay that starts and remains activated for 8 seconds, each time the hand comes near the No-touch sensor's range of action.
- 1 adhesive cover in polycarbonate, 180 x 30 mm, R2,5, thickness 0.3 mm with 7-colour international symbols.

ordering information

Q.ty

Models for 12Vdc/70mA power supply

MODELS

N°

Assembly type 1

fully aligned concealed for recess-mounting without flange on the same plane of the door frame panel *

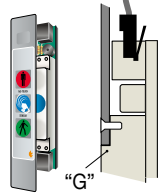

SLIM-DUALUX No-touch stop and go display type 1 "CLICK & GO" technology with fully aligned concealed for recess-mounting on the same plane of the door frame panel without flange.

Ideal to achieve a "smooth" surface (without roughness) that is easy to clean. Supplied with diffuser screen and gap G for sections with a thickness of 1.6 mm. Complete with self-adhesive cover designed to be applied after the final installation of the system.

* In this case it is advisable to prepare the recess during the door frame machining.

034981HW2U

Same with diffuser screen and gap G for sections with a thickness of 3 mm.

034981HW2U3

Assembly type 2

fully aligned at milling for recess-mounting with front flange on the same plane of the panel surface ◆

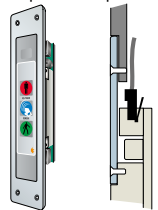

SLIM-DUALUX No-touch stop and go display type 2 "CLICK & GO" technology for aligned recessed flush fitting in bottom of panel using front flange (e.g. To mount on wall panel next to the door frame on the post where no chasing can be carried out).

Supplied with front flange in anodized aluminium with "silver" finish - 250 x 50 mm, thickness 2.5 mm for recess-mounting on the same plane of the panel surface for aligned recessed flush fitting in bottom of plane using front flange. Cover pre-assembled and fixed into the flange niche.

◆ In this case, it is advisable to prepare sunk milling during the panel machining phase.

034982HW2U

Assembly type 3

for conventional flush mounting with front flange overlapping door frame

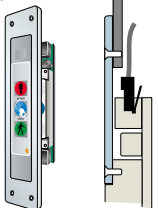

SLIM-DUALUX No-touch stop and go display type 3 "CLICK & GO" technology for traditional recessed fitting using flange.

Supplied with front flange in anodized aluminium with "silver" finish - 250 x 50mm, thickness 4 mm for flush mounting. Cover pre-assembled and fixed into the flange niche.

Mounting can be carried out "on site", directly onto the installed door frame.

034983HW2U

Assembly type 4

for surface mounting with using housing

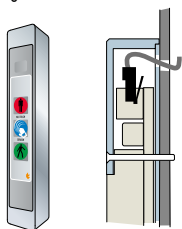

SLIM-DUALUX No-touch stop and go display type 4 "CLICK & GO" technology for mounting placed on surface using housing.

With extra-strong protective housing, made in anodized silver finish aluminium (35 x 25 x 215 mm).

Self-adhesive cover in polycarbonate, provided separately and designed to be used as final cover to hide the 4 fixing screws of the housing on the door frame.

Useful when you wish to avoid recess-mounting or cuts on the door frame.

034984HW2U

Assembly type 5

for recessed wall-mounting with flange and wall-mounting receptacle

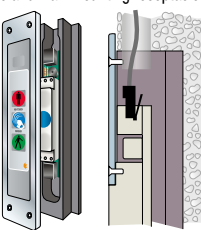

SLIM-DUALUX No-touch stop and go display type 5 "CLICK & GO" technology for recessed assembly using flange and wall box.

Supplied with front flange in anodized aluminium with "silver" finish - 250 x 50 mm, thickness 4 mm, to be fixed to the housing by placing on wall surface.

Self-adhesive cover in polycarbonate pre-assembled and fixed into the flange niche.

Also fitted with wall box with "wings" for rapid anchoring (65 x 30 x 230 mm), in plastic taken from single block to be assembled "in a niche" in the wall to house the body of the stop and go display No-touch.

Wall niche and cable channel to be prepared beforehand.

034983HW2U

Special configurations available at extra charge: Cover with your logo and/or customized.

For sizes, measurements and details of chasing, application examples and connection diagrams, see page 20.

SLIM-DUALUX No-touch STOP & GO DISPLAYS - sizes, application examples and connection diagram

Assembly type 1 fully aligned concealed for recess-mounting on the same plane of the door frame panel without a flange

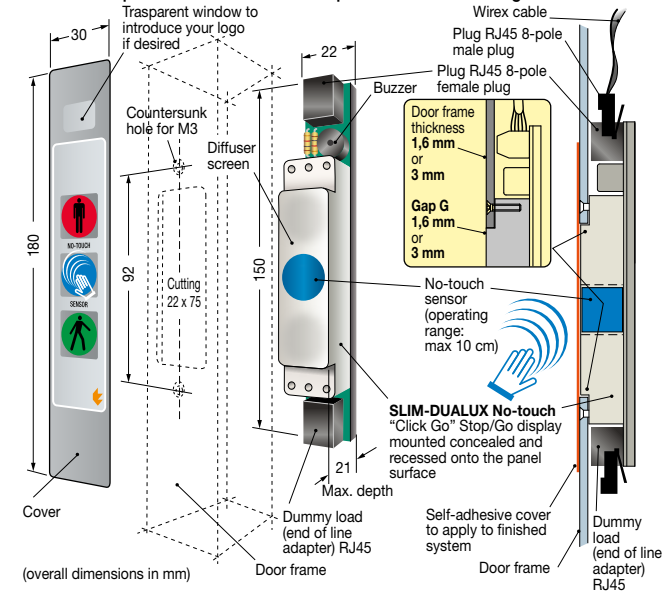

Assembly type 2 fully aligned at milling for recess-mounting with front flange on the same plane of the panel surface

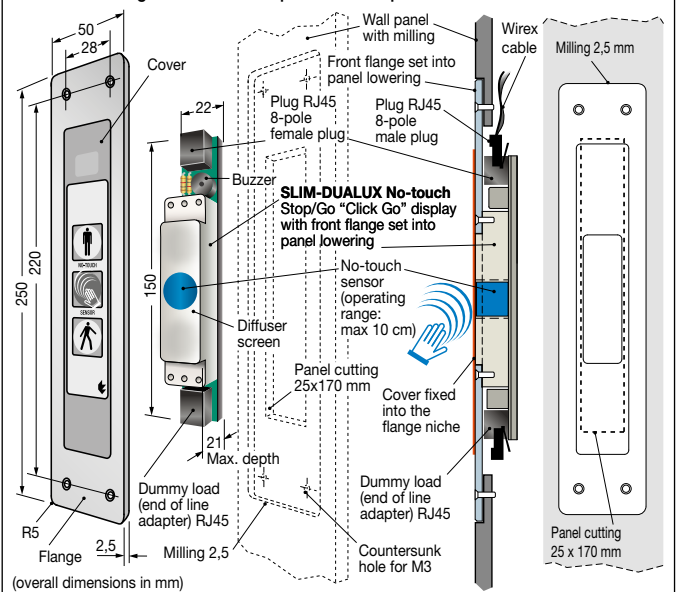

Assembly type 3 for conventional flush mounting with front flange overlapping door frame

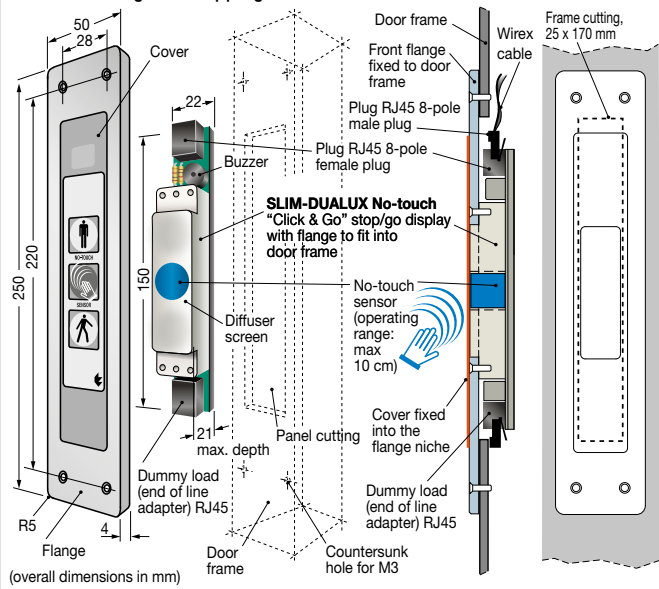

Assembly type 4 for surface mounting with using housing

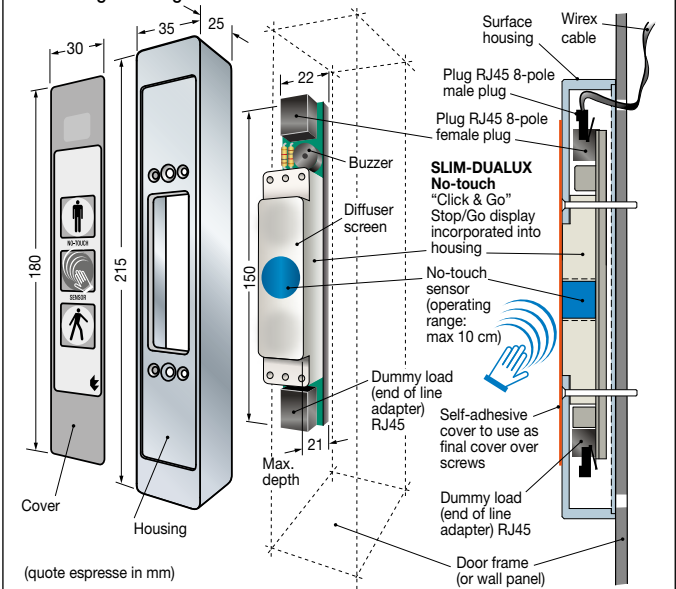

Assembly type 5 for recessed mounting in wall-mounting receptacle with flange and wall-mounting receptacle

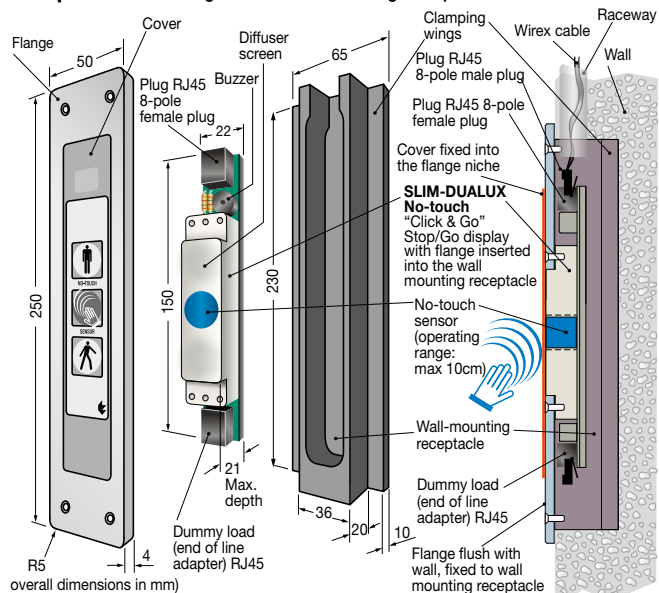

Examples of Wirex fast connecting cables for "CLICK & GO" models

