

# SLIM-CODEGUARD

## PROFESSIONAL KEYPADS WITH ACCESS CODES

With quick fitting 8 pole RJ45 plug to simplify installation and wiring

Export Product-list  
January 2018



TECNODIMENSIONE®



Ordering information

Q.ty

MODELS

N°

Models for 12Vdc/70mA power supply (on request on order models 24Vdc)

Programmable and modifiable without limitations directly on site using the keypad (by entering the proprietary programming code, that can also be customised on-site).

Length of access code: 2-8 digits (programmable).

- "CLICK & GO" technology, with 1 RJ45 8-pole quick fitting female plug for connection to PHARMATRONIX control unit.

- 8 alphanumeric keys + Enter key for entering the codes.

- 2VDC/70 mA power supply.

- NO → NC output contact (for code recognition), 12VDC/1A rating for door opening control, timed at app. 5 seconds.

- two-color R/G LED + buzzer to confirm the opening of the door.

- 1 self-adhesive cover in polycarbonate, 180 x 30 mm R2,5 - thickness 0.3 mm, with international symbols, available in 7 colours, designed to be applied after the final installation of the system.



### Assembly type 1

fully aligned concealed for recess-mounting without flange on the same plane of the door frame panel \*

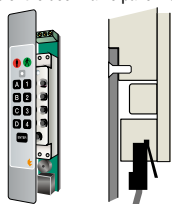

SLIM-CODEGUARD access code keypad, Type 1 "CLICK & GO" technology, with fully aligned concealed for recess-mounting on the same plane of the door frame panel without a flange. Ideal to achieve a surface (without roughness) that is easy to clean. Supplied with front panel and gap G for sections with a thickness of 1.6 mm. Complete with self-adhesive cover designed to be applied after the final installation of the system.

\* In this case it is advisable to prepare the recess during the door frame machining.

Same with front panel and gap G for sections with a thickness of 3 mm.

034991NW2U

034991NW2U3

### Assembly type 2

fully aligned at milling for recess-mounting with front flange on the same plane of the panel surface ◆

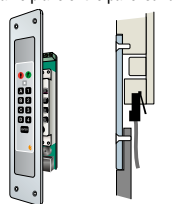

SLIM-CODEGUARD access code keypad, Type 2 "CLICK & GO" technology, for aligned recessed flush fitting in bottom of panel using front flange (e.g. To mount on wall panel next to the door frame on the post where no chasing can be carried out).

Supplied with front flange in anodized aluminium with "silver" finish - 250 x 50 mm, thickness 2.5 mm for recess-mounting on the same plane of the panel surface for aligned recessed flush fitting in bottom of plane using front flange.

Cover pre-assembled and fixed into the flange niche.

◆ In this case, it is advisable to prepare sunk milling during the panel machining phase.

034992NW2U

### Assembly type 3

for conventional flush mounting with front flange overlapping door frame

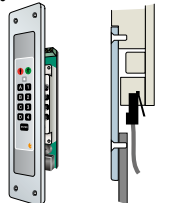

SLIM-CODEGUARD access code keypad, Type 3 "CLICK & GO" technology, for traditional recessed fitting using flange.

Supplied with front flange in anodized aluminium with "silver" finish - 250 x 50mm, thickness 4 mm for flush mounting.

Cover pre-assembled and fixed into the flange niche.

Mounting can be carried out "on site", directly onto the installed door frame.

034993NW2U

### Assembly type 4

for surface mounting with using housing

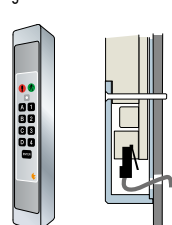

SLIM-CODEGUARD access code keypad, Type 4 "CLICK & GO" technology, for mounting placed on surface using housing.

With extra-strong protective housing, made in anodized silver finish aluminium (35 x 25 x 215 mm).

Self-adhesive cover in polycarbonate, provided separately and designed to be used as final cover to hide the 4 fixing screws of the housing on the door frame.

Useful when you wish to avoid recess-mounting or cuts on the door frame.

034994NW2U

### Assembly type 5

for recessed wall-mounting with flange and wall-mounting receptacle

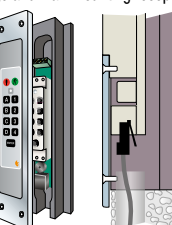

SLIM-CODEGUARD access code keypad, Type 5 "CLICK & GO" technology, for recessed assembly using flange and wall box.

Supplied with front flange in anodized aluminium with "silver" finish - 250 x 50 mm, thickness 4 mm, to be fixed to the housing by placing on wall surface.

Self-adhesive cover in polycarbonate pre-assembled and fixed into the flange niche.

Also fitted with wall box with "wings" for rapid anchoring (65 x 30 x 230 mm), in plastic taken from single block to be assembled "in a niche" in the wall to house the body of the keypad.

Wall niche and cable channel to be prepared beforehand.

034995NW2U

Special configurations available at extra charge: Cover with your logo and/or customized.

For sizes, measurements and details of chasing, application examples and connection diagrams, see page 36.

**Detail of the components and control buttons of the unit**  
**SLIM-CODEGUARD**

Example of "Click & Go" connection via Masterwirex cable

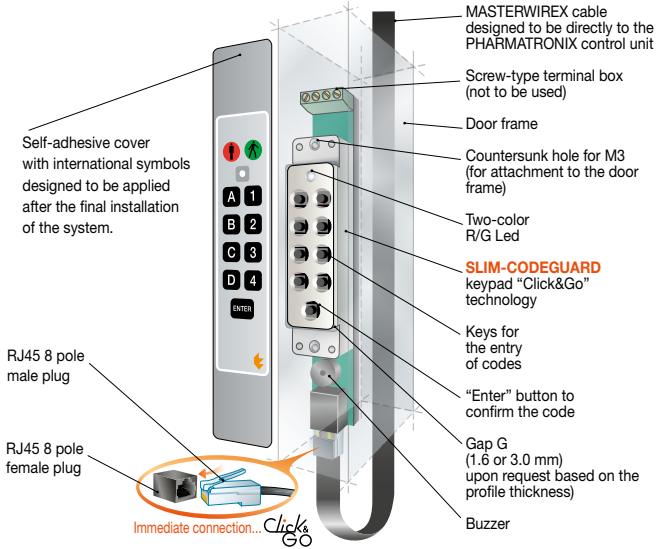

**Assembly type 1** fully aligned concealed for recess-mounting on the same plane of the door frame panel without a flange

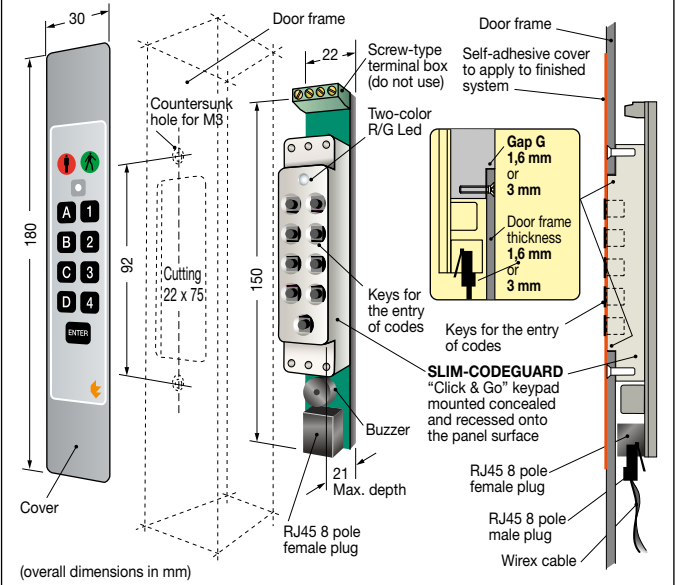

**Assembly type 2** fully aligned at milling for recess-mounting with front flange on the same plane of the panel surface

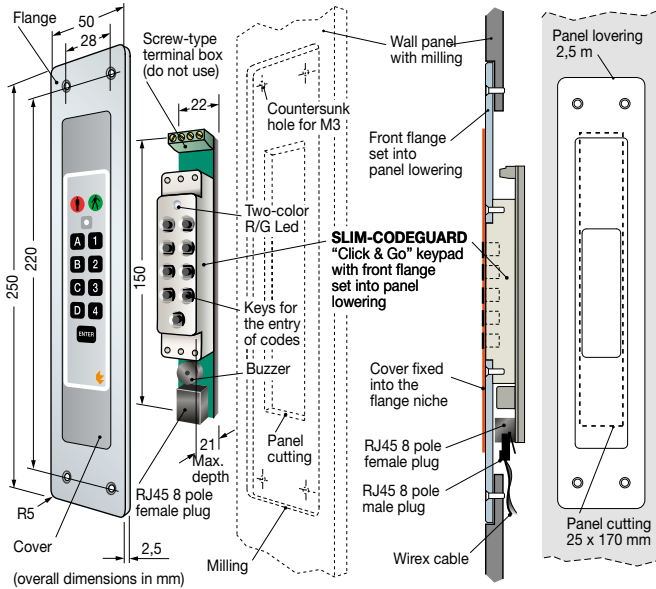

**Assembly type 3** for conventional flush mounting with front flange overlapping door frame

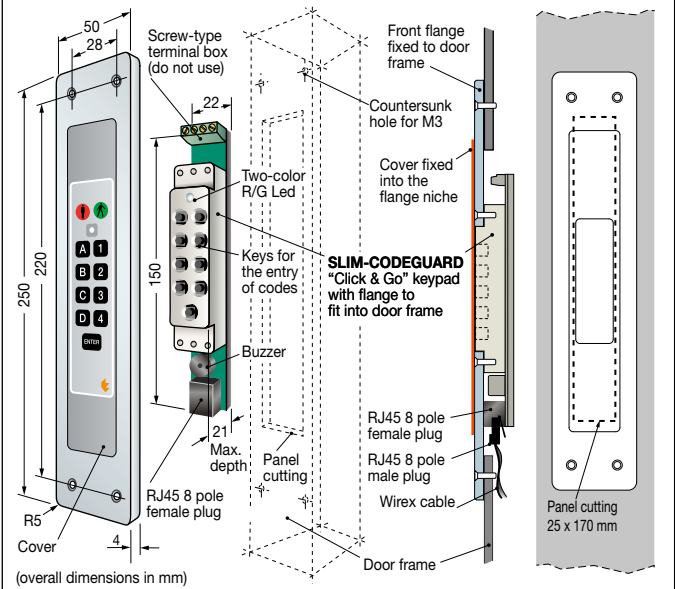

**Assembly type 4** for surface mounting with using housing

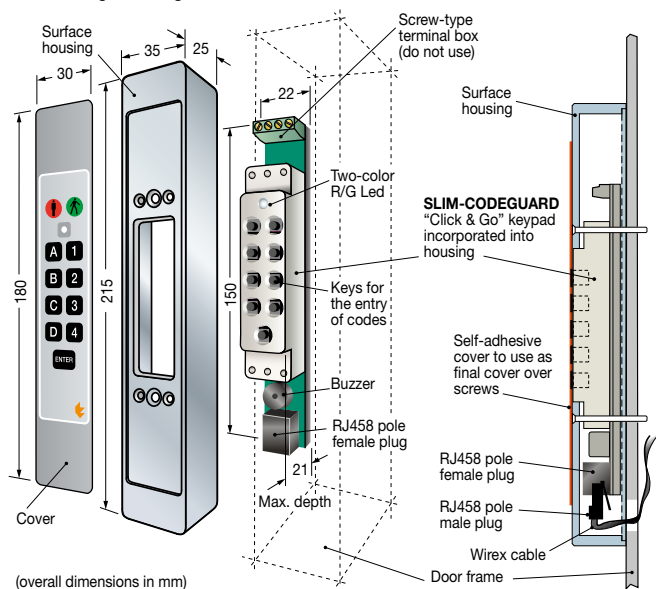

**Assembly type 5** for recessed mounting in wall-mounting receptacle with flange and wall-mounting receptacle

