

Solenoid drop bolts, electrical door strikes and electromagnets in "CLEAN COVER" case made by solid block of anodised aluminium.

No cutting the frame
no work on internal frame grain!

Only a portable drill is needed to easily install **DRILL&GO** devices on any frame.

DRILL & GO

Cut-Free®

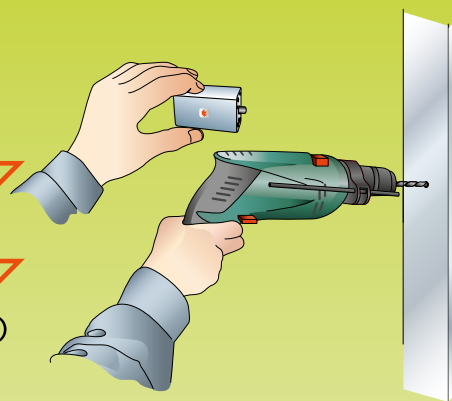

innovation
FOR EASY INSTALLATION
SURFACE MOUNT

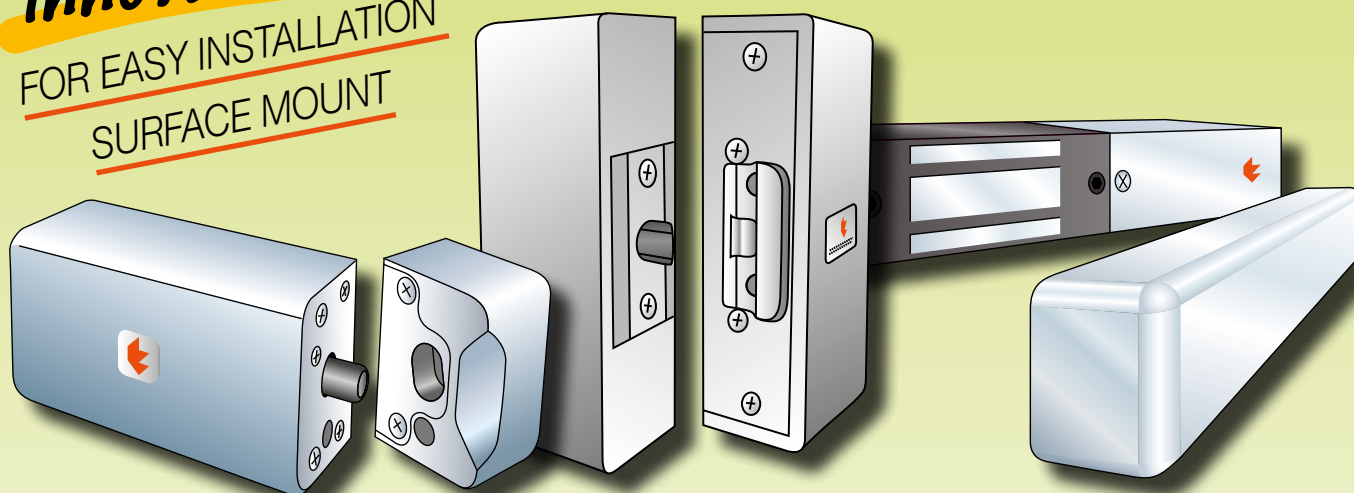

MICROREDLOCK
in "CLEAN COVER"
for surface-mounting

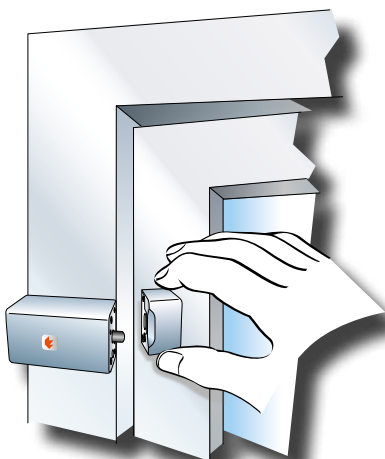

SLIM-DOORSTRIKE
in "CLEAN COVER"
for surface-mounting

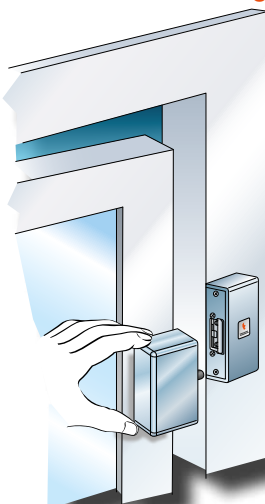

SLIM-MINISENTRYLOCK
in "CLEAN COVER"
for surface-mounting

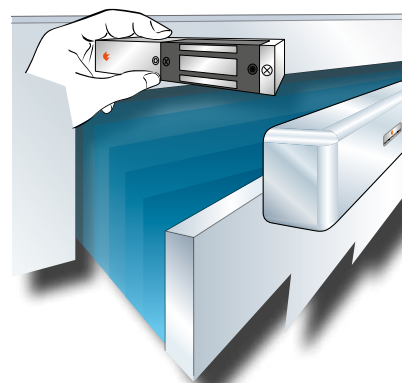

MICROREDLOCK, SLIM-DOORSTRIKE, SLIM-MINISENTRYLOCK

All provided with a "CLEAN COVER" made from silver-coloured, solid anodized aluminium, ultra-slim, designed to be easily installed on the door surface without any holes and/or cuts in the frame...
... it's **DRILL&GO CUT-FREE!**

INNOVATION

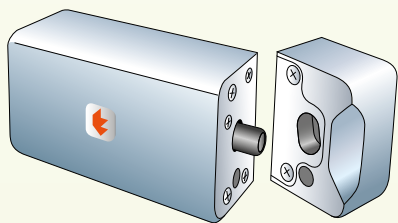

**FOR SURFACE
MOUNTING**

innovation

MICROREDLOCK in "CLEAN COVER" for surface mount

PROFESSIONAL TECNODIMENSIONE ELECTRICAL DROP BOLTS

For easy surface mount with full coverage
"CLEAN COVER" made by solid block of anodised aluminium.

One unit... for **4** different needs.

- 1st** No frame cutting nor work on internal nervures.
Just drill to install = **DRILL&GO CUT-FREE**
- 2nd** Conventional wiring installation with screw-type
terminal board = **FLEXICON**
- 3rd** Housed into CLEAN COVER fully made by a solid block
of anodised aluminium, easy to clean with appropriate
detergents = **CLEAN**
- 4th** Fail-safe; it automatically unlocks in the event
of power failure freeing the door for emergency exit
also in the event of fire = **FAIL-SAFE**

IDEAL FOR SURFACE APPLICATIONS
ON "CLEAN ROOM" LOCKS.

1st DRILL&GO CUT-FREE

**DRILL&
Go**
Cut-Free®



MICROREDLOCK

it is ultra-slim, designed to be easily installed
on the door surface without any
holes and/or cuts in the frame...
... it's **DRILL&GO CUT-FREE!**

2nd flexi con MULTIFUNCTIONAL INPUTS/OUTPUTS

Ideal for the installation on
existing door frames in combi-
nation with conventional wiring
systems and to be interfaced
with any control unit such as
PLC, microprocessor boards or
conventional electronics.....

....it's **FLEXICON!**

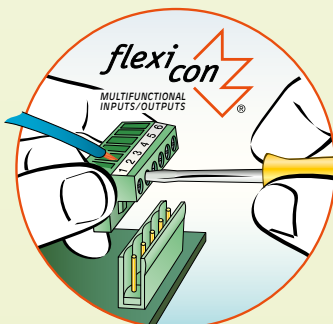

3rd CLEAN

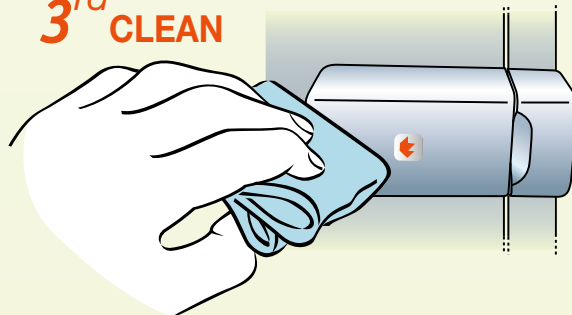

MICROREDLOCK

housed into protective smooth "**CLEANCOVER**"
(roughness-free) ...
easy to clean with appropriate detergents...
... it's **CLEAN!**

4th FAIL-SAFE



MICROREDLOCK

Automatic fail-safe unlock = bolt "in"
without power, bolt "out" when powered.
In the event of fire or power failure it
automatically unlocks freeing the exit...

... it's **FAIL-SAFE!**

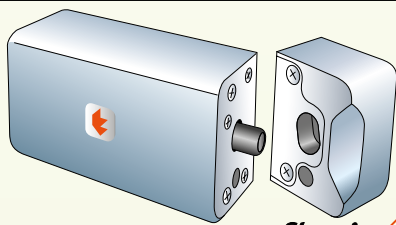

flexicon
MULTIFUNCTIONAL
INPUTS/OUTPUTS

UNIVERSAL ELECTRICAL DROP BOLTS

MICROREDLOCK

in "CLEAN COVER"
for surface-mounting

Export Product-list
January 2018



TECNODINENSIONE®

Mini-electrical drop bolt with full coverage "CLEAN COVER" made by solid block of anodised aluminium. Ideal for surface mount and surface applications on any type of "CLEAN ROOM" door frame.

Ordering information



Q.ty

MODELS

N°

MICROREDLOCK

for surface mounting in protective "CLEAN COVER" housing

Element "A" = housing with mini electrical drop bolt

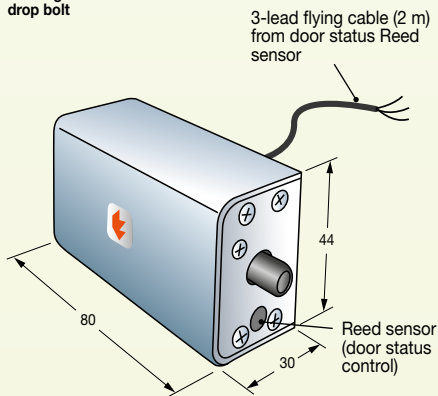

Element "B" = block counter (stricke)

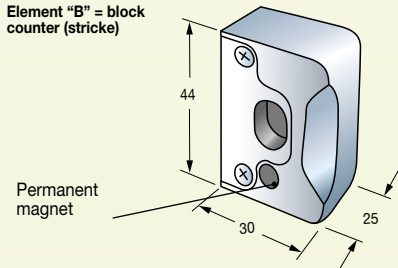

(overall dimensions in mm)

Ultra compact MICROREDLOCK mini-electrical drop bolt housed in protective "smooth" (roughness-free) and easy to clean case. Manageable and easy to install on door surfaces without any need to drill and/or cut door frames.

Models for 12 Vdc power supply

MICROREDLOCK "FLEXICON" electrical drop bolt in "CLEAN COVER" case complete with 1 flying 3-lead cable 2 m long (factory pre-cabled on unit), from the door status Reed sensor + 1 screw terminal board on electrical drop bolt for power connections. Protective Anticorodal, anodised and mechanically brushed aluminium "CLEAN COVER" made by solid block for easy installation with concealed retractable non-removable bracket.

The kit contains two components:

element "A": is the case that includes the electrical drop bolt to be secured on the door counter frame.

element "B": is the loose reference bolt to be secured on the door leaf frame matching element "A".

- FAIL-SAFE (anti-panic = unlock without power) version with 100% ED coil for a continuous operation.
- Includes a Reed sensor to control door status.
- Power supply 12 V DC/390 mA.
- Element A dimensions 80 x 30 x 44 mm
- Element B dimensions 25 x 30 x 44 mm
- Weight g 320

00803A2RCZM
Lh/Rh reversible

Models for 24Vdc power supply (on request)

Models with 24Vdc power supply (on request)
Mini-electrical drop bolt for MICROREDLOCK "FLEXICON" surface mount in "CLEAN COVER" like above but with 24Vdc/140mA power.

00803A4RCZM

MICROREDLOCK mini-electrical drop bolt in "CLEAN COVER" installation method

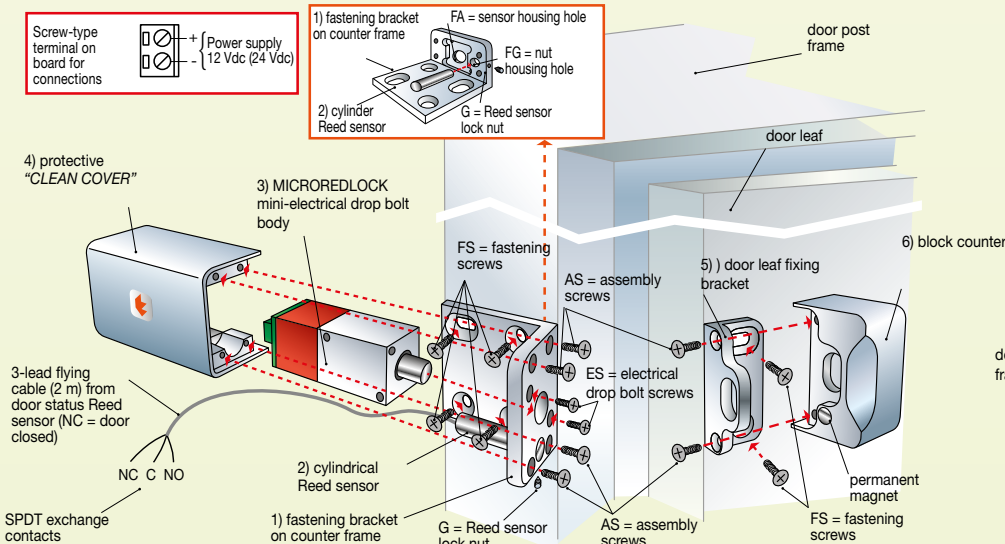

Example of a door complete with permanently assembled MICROREDLOCK mini-electrical drop bolt

element "A" (mini-electrical drop bolt) element "B" (block counter)

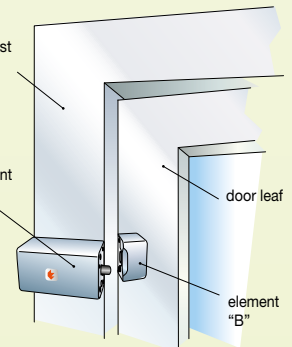
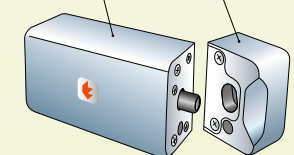

Note:

AS = 6 supplied assembly screws
ES = 2 supplied electrical drop bolt screws.

FS = 6 fastening screws supplied by the installer (based on the type of door frame).

G = 1 supplied nut.

Element "A" exploded view

"CLEAN COVER" that includes the mini-electrical drop bolt (to be secured on the counter frame)

Element "A" assembly sequence
to be secured on counter frame:

- secure the bracket (1) on the counter frame with the four FS fastening screws.
- place the cylinder Reed sensor (2) in the matching FA hole.
- lock the sensor by screwing the G nut into the FG hole.
- secure the mini-electrical drop bolt body (3) to the bracket (1) with the two supplied ES screws.
- insert the protective cover (4) over the assembled electrical drop bolt (3), + bracket (1) + sensor (2). Complete by securing the case (4) with the four supplied AS assembly screws that bind the components.

Element "B" exploded view

"CLEAN COVER" that includes the block counter bolt (to be secured on the door leaf)

Element "B" assembly sequence
to be fastened on the door leaf

- secure the bracket (5) on the door leaf with the two FS fastening screws.
- insert the block counter bolt (6) on the bracket and fasten together with the two supplied AS assembly screws that bind the two components together.

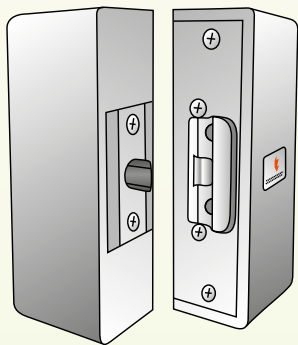

FOR SURFACE
MOUNTING

innovation

SLIM-DOORSTRIKE

in "CLEAN COVER" for surface mount

PROFESSIONAL TECNODIMENSIONE

ULTRA COMPACT ELECTRICAL DOOR STRIKE

For easy surface mount with full coverage "CLEAN COVER" made by single block of anodised aluminium.

One unit...

for 4 different needs.

- 1st No frame cutting nor work on internal nervures.
Just drill to install = **DRILL&GO CUT-FREE**
- 2nd Conventional wiring installation with screw-type terminal board = **FLEXICON**
- 3rd Housed into CLEAN COVER fully made by single block of anodised aluminium, easy to clean with appropriate detergents = **CLEAN**
- 4th Fail-safe; it automatically unlocks in the event of power failure freeing the door for emergency exit also in the event of fire = **FAIL-SAFE**

IDEAL FOR SURFACE APPLICATIONS
ON "CLEAN ROOM" LOCKS.

1st

**DRILL&GO
CUT-FREE**

**DRILL&
Go**
Cut-Free®

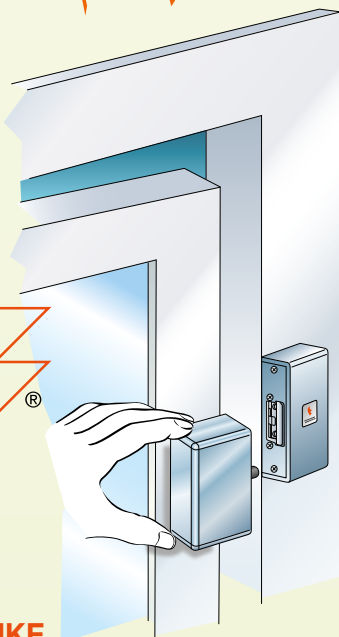

SLIM-DOORSTRIKE

it is ultra slim, designed to be easily installed on the door surface without any holes and/or cuts in the frame...

...it's **DRILL&GO CUT-FREE!**

2nd **flexi**con
MULTIFUNCTIONAL
INPUTS/OUTPUTS

Ideal for the installation on existing door frames in combination with conventional wiring systems and to be interfaced with any control unit such as PLC, microprocessor boards or conventional electronics....

....it's **FLEXICON!**

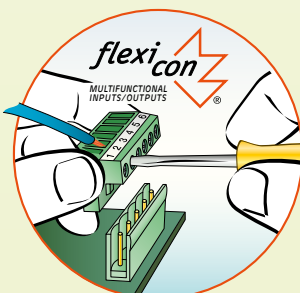

3rd

CLEAN

SLIM-DOORSTRIKE

housed into protective smooth

"CLEAN COVER"

(roughness-free) ...

easy to clean with

appropriate detergents...

... it's **CLEAN!**

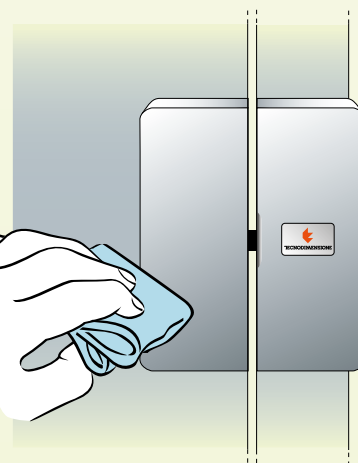

4th

FAIL-SAFE



SLIM-DOORSTRIKE

Automatic fail-safe unlock.

In the event of fire or power failure it automatically unlocks freeing the exit...

... it's **FAIL-SAFE!**

INNOVATION

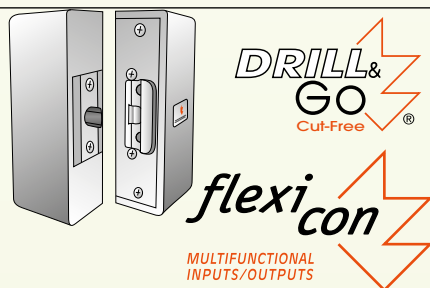

ULTRA COMPACT ELECTRICAL DOOR STRIKE

SLIM-DOORSTRIKE

in "CLEAN COVER"

by single block for surface mount

Export Product-list
January 2018



TECNODIMENSIONE®

Electrical door strike with full coverage "CLEAN COVER" made by single block of anodised aluminium.
Ideal for surface mount and surface applications on any type of "CLEAN ROOM" door frame.

Ordering information



Q.ty

MODELS

N°

SLIM-DOORSTRIKE

for surface mounting in protective "CLEAN COVER" housing

Element "A" =
CLEANCOVER housing
lock with mini spring bolt

Element "B" =
CLEANCOVER
housing with door strike

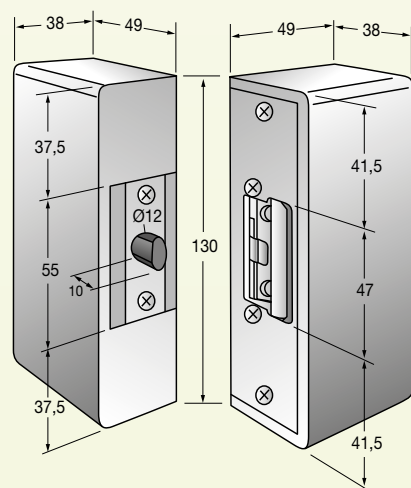

(overall dimensions in mm)

Ultra compact SLIM-DOORSTRIKE "FLEXICON" electrical door strike housed into protective "smooth" (roughness-free) and easy to clean case.
Manageable and easy to install on door surfaces without any need to drill and/or cut door frames.

Models for 12 Vdc power supply

SLIM-DOORSTRIKE electrical door strike for conventional mount with "FLEXICON" technology and screw terminal board for conventional connection to any system, even pre-existent.
SLIM-DOORSTRIKE "FLEXICON" electric door strike with screw-type terminal board, suitable for connections with any control unit such as PLC, microprocessor boards or conventional electronics.

The kit contains two components:

element "A": is the case that includes the electrical reference to be secured on counter frame.

element "B": is the loose reference bolt to be secured on the door leaf frame matching element "A".

- FAIL-SAFE (anti-panic = unlock without power) version with 100% ED coil for a continuous operation.
- Includes a Reed sensor to control door status.
- Power supply 12 V DC/390 mA.
- Overall dimensions 137 x 49 x 38 mm (for each of the two units)
- Weight kg 1,100

0158J12DCM

Lh/Rh reversible
kit for pull-open
doors

0158J12SCM

Lh/Rh reversible
kit for push-open
doors

Models for 24Vdc power supply (on request)

Electrical door strike for surface mount
SLIM-DOORSTRIKE "FLEXICON" in "CLEAN COVER" idem c.s.
like above but with 24Vdc/140mA power.

0158J14DCM

0158J14SCM

SLIM-DOORSTRIKE "FLEXICON" ELECTRICAL BOLT IN "CLEAN COVER" ASSEMBLY METHOD

"A" element exploded view
Housing protective which includes mini spring bolt
(to be mounted on door)

"B" element exploded view
Housing protective "CLEAN COVER" which includes
electrical door strike (to be mounted on door-post)

Example of one door complete
with doorstrike
CLEANCOVER-DOORSTRIKE
unit finally mounted

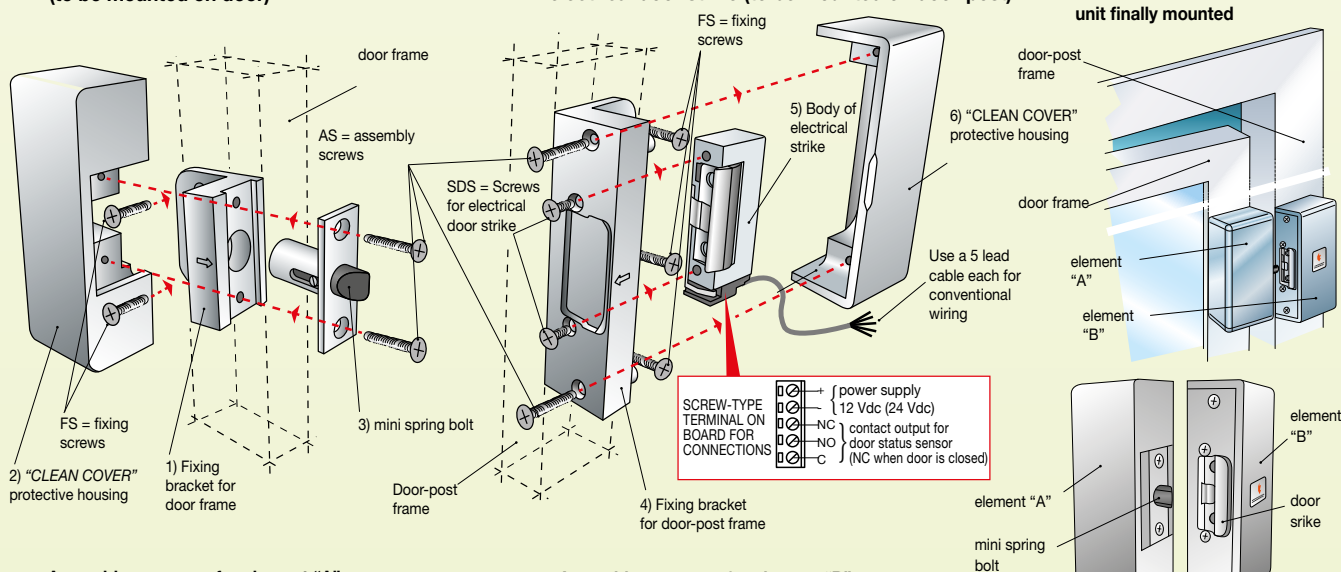

Assembly sequence for element "A"

to be mounted on door frame:

- secure the bracket (1) on the door with the two FS fixing screws
- Insert the protective housing (2) to cover the bracket (1).
- insert the mini spring bolt (3) in the hole in the bracket and assembly all parts with the two supplied pass-through AS screws that link all the three parts together.

Assembly sequence for element "B"

to be mounted on door-post frame:

- secure the bracket (4) on the door-post with three FS fastening screws.
- secure the electrical door strike body (5) with the two SDS screws supplied with the bracket (4).
- insert the protective housing (6) to cover the bracket (4) with electrical door strike (5) and connect all parts with the two AS supplied pass-through screws that link all the three parts together.

Note:

AS = 4 assembly screws
(+ SDS = 2 screws for electrical
door strike) supplied together.

FS = 5 fixing and fastening screws
on frame should be provided by
installer (based on type of frame).

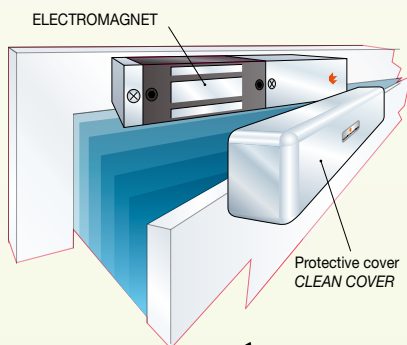

**FOR SURFACE
MOUNTING**

innovation

SLIM-MINISENTRYLOCK in "CLEAN COVER"

TECNODIMENSIONE PROFESSIONAL ELECTROMAGNETS

Frontal door safety locks. Mini-compact unit with one-piece "CLEAN COVER" made of anodised aluminium.

One unit...
for **4** different needs.

- 1st** No frame cutting nor work on internal nervures.
Just drill to install = **DRILL& GO CUT-FREE**
- 2nd** Conventional wiring installation with screw-type terminal board = **"FLEXICON"**
- 3rd** Housed into CLEAN COVER fully made by single block of anodised aluminium, easy to clean with appropriate detergents = **CLEAN**
- 4th** Fail-safe; it automatically unlocks in the event of power failure freeing the door for emergency exit also in the event of fire = **FAIL-SAFE**

IDEAL FOR SURFACE APPLICATIONS
ON "CLEAN ROOM" LOCKS.

**1st
DRILL&GO
CUT-FREE**



SLIM-MINISENTRYLOCK
it is ultra slim, designed to be easily installed
on the door surface without any
holes and/or cuts in the frame...
... it's **CUT-FREE!**

**3rd
CLEAN**

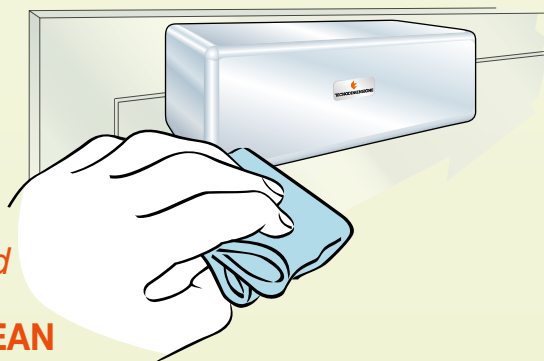

SLIM-MINISENTRYLOCK
housed into protective smooth **"CLEANCOVER"**
(roughness-free) ...
easy to clean with appropriate detergents...
... it's **CLEAN!**

2nd flexi^{con}
MULTIFUNCTIONAL
INPUTS/OUTPUTS

Ideal for the installation on
existing door frames in
combination with conventional
wiring systems and to be
interfaced with any control unit
such as PLC, microprocessor
boards or conventional
electronics.....

....it's **FLEXICON!**

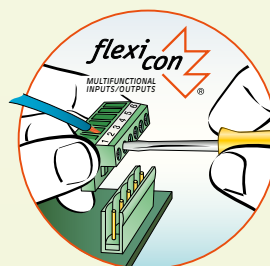

**4th
FAIL-SAFE**



SLIM-MINISENTRYLOCK
Automatic fail-safe unlock.
In the event of fire or power failure it
automatically unlocks freeing the exit...
... it's **FAIL-SAFE!**

INNOVATION

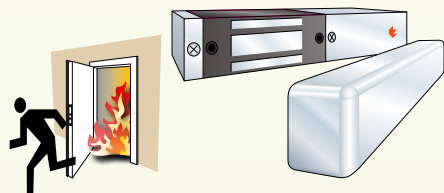

Automatic panic release and crash bar. In case of fire, when there is no power, it automatically releases, freeing the exit...it's FAIL-SAFE!

PROFESSIONAL MINI ELECTROMAGNETS SLIM-MINISENTRYLOCK in "CLEAN COVER"

Eletromagnetic crush-safe lock

Mini electromagnet with full coverage "CLEAN COVER" made by single block of anodised aluminium. Ideal for surface mount and surface applications on any type of "CLEAN ROOM" door frame.

Export Product-list
January 2018



TECNODINENSIONE®

Ordering information



Q.ty

MODELS

N°

SLIM- MINISENTRYLOCK "FLEXICON"

for surface mounting in protective "CLEAN COVER" housing

Element "A" = body of electromagnet

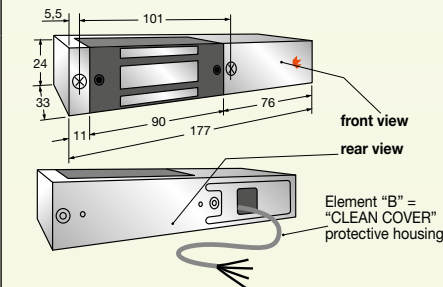

Element "B" = "CLEAN COVER" protective housing

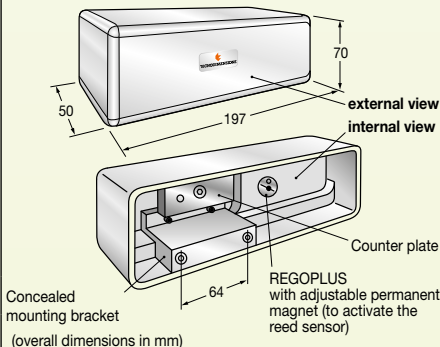

Ultra compact mini electromagnet SLIM-MINISENTRYLOCK "FLEXICON" encased in protective "smooth" (roughness-free) and easy to clean case. Manageable and easy to install on door surfaces without any need to drill and/or cut door frames.

Models for 12 Vdc power supply

SLIM-MINISENTRYLOCK "FLEXICON" mini electromagnet in "CLEAN COVER" case complete with 4-lead flying cable (2 m) of which 2 from the door status sensor and 2 for power. The unit can be interfaced with any control unit such as PLC, microprocessor boards or conventional electronics

The kit contains two components:

element "A": is the **electromagnet** (to be fitted to the top rail of the door frame) and

element "B": which is the **protective "CLEAN COVER"** (to be fitted over component "A" on the upper side of door leaf).

- 12 Vdc/70 mA power supply (units with very low consumption).
- Pressure resistance 60 Kp (equivalent to 600 Newton) to be enough and prevent adequately un-authorized opening of the door.

- Frontal lock with strike plate (armature)

- Adjustable Regoplus proximity reed sensor for controlling door status with 1A SPDT switch.

- Protective Anticorodal, anodised and mechanically brushed aluminium "CLEAN COVER" made by single block for easy installation with concealed non-removable bracket.

- Dimensions 197x70x50mm

- Weight Kg 1.55

Models for 24 Vdc power supply

SLIM-MINISENTRYLOCK "FLEXICON" electromagnet as above but for a 24 V DC /50 mA power supply

0020804A2UM

0020804A4UM

CROSS SECTION VIEW

Element "A" Electromagnet
SLIM-MINISENTRYLOCK

Element "B"
protective cover
"CLEAN COVER"

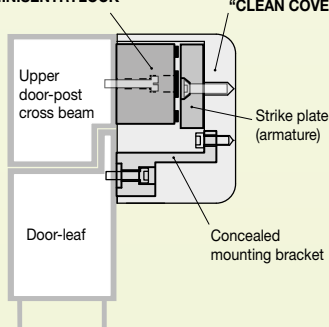

EXAMPLES OF WIREX FAST CONNECTING CABLES FOR "FLEXICON" MODELS

ELEMENT "A"

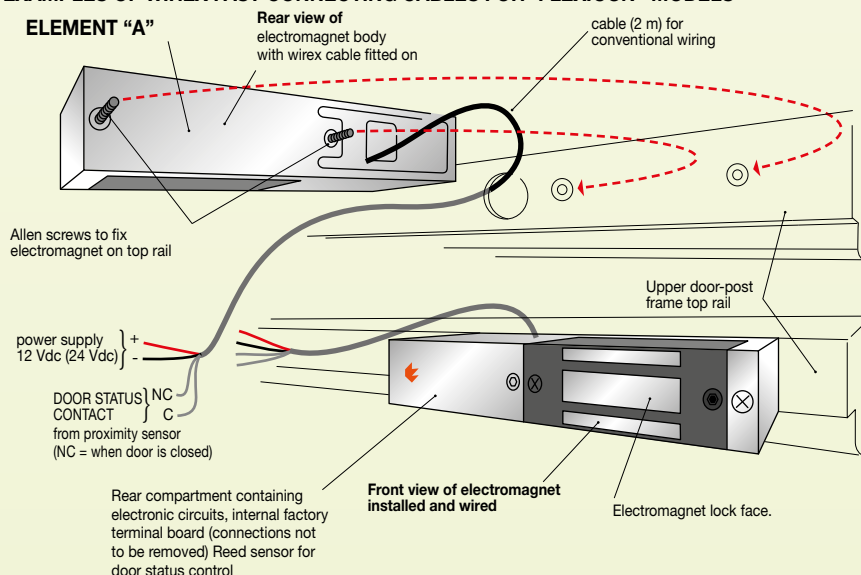

Allen screws to fix
electromagnet on top rail

power supply
12 Vdc (24 Vdc)

DOOR STATUS } NC
CONTACT } C
from proximity sensor
(NC = when door is closed)

Rear compartment containing
electronic circuits, internal factory
terminal board (connections not
to be removed) Reed sensor for
door status control

Front view of electromagnet
installed and wired

Electromagnet lock face.

ELEMENT "B"

Protective cover
"CLEAN COVER"
internal view

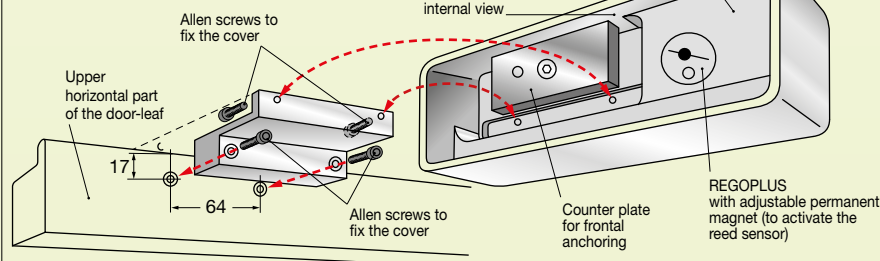

Allen screws to
fix the cover

Upper
horizontal part of the door-leaf

Allen screws to
fix the cover

Counter plate
for frontal
anchoring

REGOPLUS
with adjustable permanent
magnet (to activate the
reed sensor)

Door open

