



SLIM-DUALUX No-touch PROFESSIONAL SENSORIZED STOP/GO DISPLAYS

Export Product-list

January 2018



TECNODINENSIONE®

Ordering information



Q.ty

MODELS

N°

Models for 12Vdc/70mA power supply

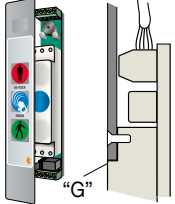
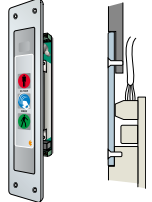
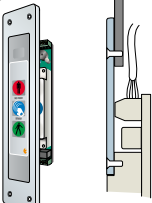
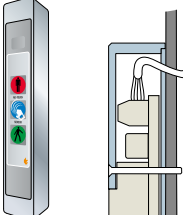
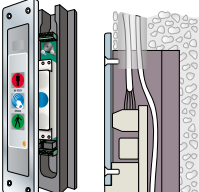
Assembly type 1 fully aligned concealed for recess-mounting without flange on the same plane of the door frame panel * 	SLIM-DUALUX No-touch stop and go display type 1 with fully aligned concealed for recess-mounting on the same plane of the door frame panel without flange. Ideal to achieve a "smooth" surface (without roughness) that is easy to clean. Supplied with diffuser screen and gap G for sections with a thickness of 1.6 mm. Complete with self-adhesive cover designed to be applied after the final installation of the system. * In this case it is advisable to prepare the recess during the door frame machining.	034981HM2U		
Assembly type 2 fully aligned at milling for recess-mounting with front flange on the same plane of the panel surface ♦ 	SLIM-DUALUX No-touch stop and go display type 2 for aligned recessed flush fitting in bottom of panel using front flange (e.g. To mount on wall panel next to the door frame on the post where no chasing can be carried out). Supplied with front flange in anodized aluminium with "silver" finish - 250 x 50 mm, thickness 2.5 mm for recess-mounting on the same plane of the panel surface for aligned recessed flush fitting in bottom of plane using front flange. Cover pre-assembled and fixed into the flange niche. ♦ In this case, it is advisable to prepare sunk milling during the panel machining phase.	034981HM2U3		
Assembly type 3 for conventional flush mounting with front flange overlapping door frame 	SLIM-DUALUX No-touch stop and go display type 3 for traditional recessed fitting using flange. Supplied with front flange in anodized aluminium with "silver" finish - 250 x 50mm, thickness 4 mm for flush mounting. Cover pre-assembled and fixed into the flange niche. Mounting can be carried out "on site", directly onto the installed door frame.	034982HM2U		
Assembly type 4 for surface mounting with using housing 	SLIM-DUALUX No-touch stop and go display type 4 for mounting placed on surface using housing. With extra-strong protective housing, made in anodized silver finish aluminium (35 x 25 x 215 mm). Self-adhesive cover in polycarbonate, provided separately and designed to be used as final cover to hide the 4 fixing screws of the housing on the door frame. Useful when you wish to avoid recess-mounting or cuts on the door frame.	034983HM2U		
Assembly type 5 for recessed wall-mounting with flange and wall-mounting receptacle 	SLIM-DUALUX No-touch stop and go display type 5 for recessed assembly using flange and wall box. Supplied with front flange in anodized aluminium with "silver" finish - 250 x 50 mm, thickness 4 mm, to be fixed to the housing by placing on wall surface. Self-adhesive cover in polycarbonate pre-assembled and fixed into the flange niche. Also fitted with wall box with "wings" for rapid anchoring (65 x 30 x 230 mm), in plastic taken from single block to be assembled "in a niche" in the wall to house the body of the stop and go display No-touch. Wall niche and cable channel to be prepared beforehand.	034984HM2U		

Special configurations available at extra charge: Cover with your logo and/or customized.

For sizes, measurements and details of chasing, application examples and connection diagrams, see page 48.

SLIM-DUALUX No-touch STOP & GO DISPLAYS - sizes, application examples and connection diagram

Assembly type 1 total alignment, lock recessed into surface without flange

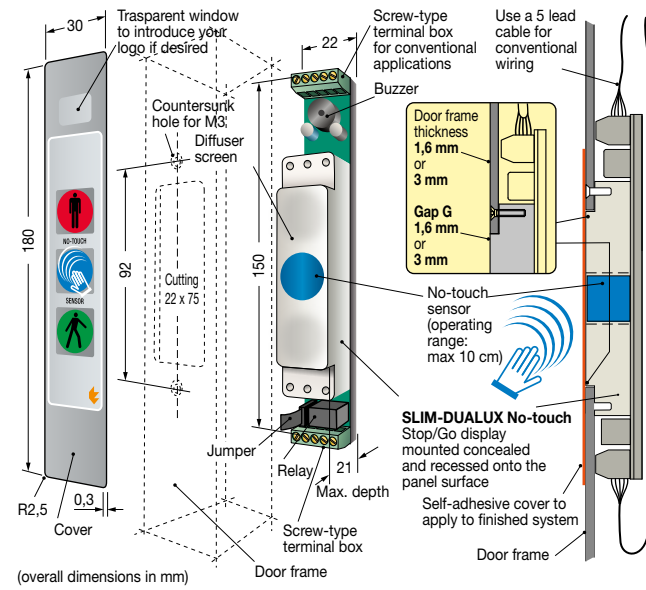

Assembly type 2 alignment at bottom with front flange "flush with surface" at bottom

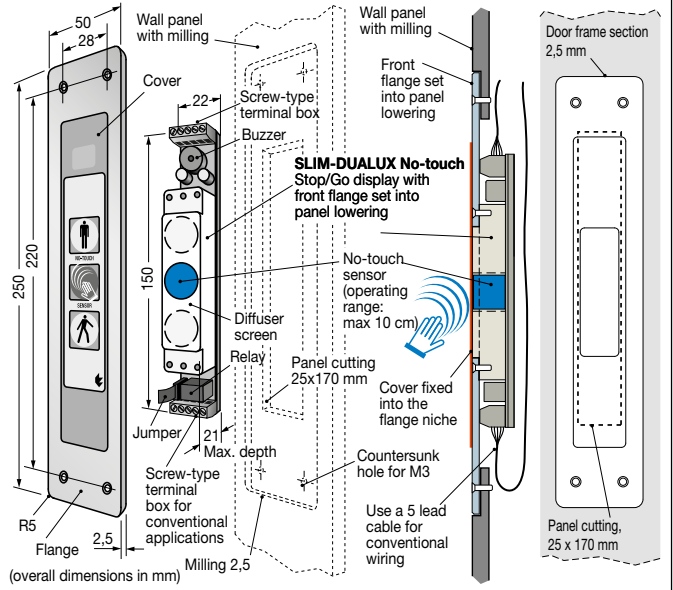

Assembly type 3 traditional fitting with front flange over the lock

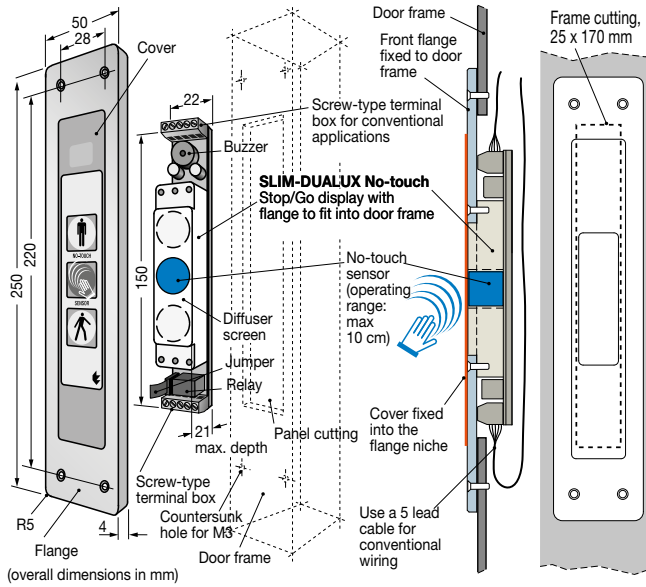

Assembly type 4 for mounting placed on surface using housing

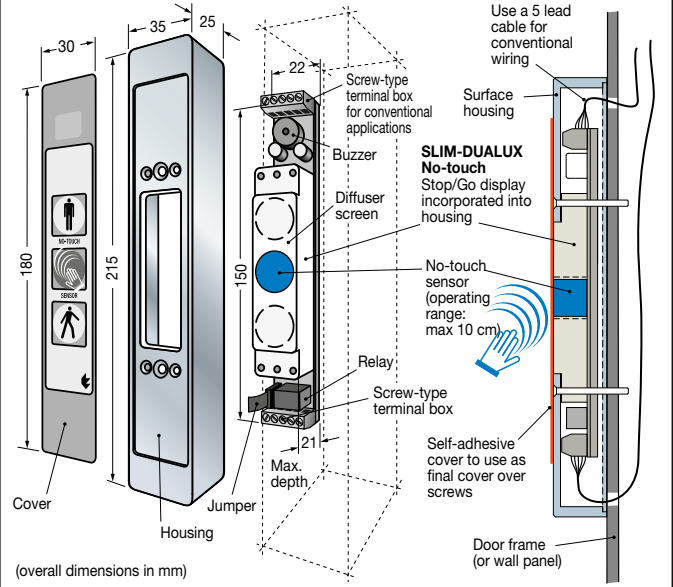

Assembly type 5 for recessed wall mounting with flange and wall box

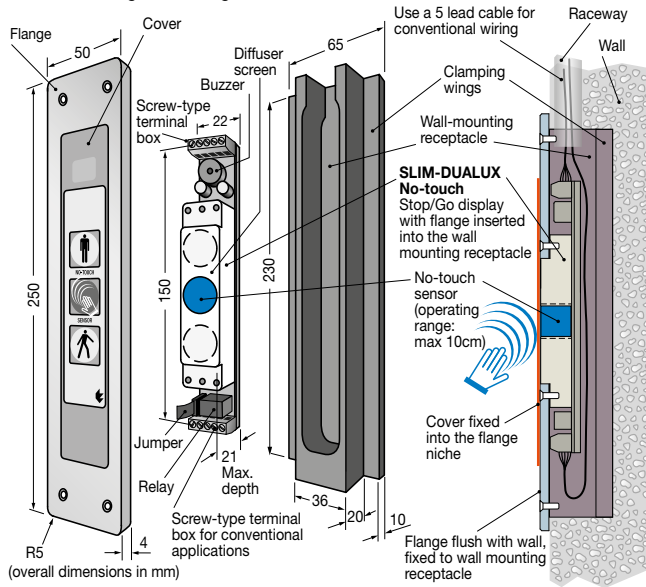

CONNECTION DIAGRAM valid for all 5 types

UPPER SCREW TYPE TERMINAL BOX

INPUT for 12 VDC light and buzzer control

- 1 = control (+) for green LED
- 2 = control (-) for green LED
- 3 = control (+) for red LED
- 4 = control (-) for red LED
- 5 = control (-) for buzzer

*JUMPER FOR CONTACT OUTPUT SETTING OF COMMAND RELAY

- a b c [] Jumper between a and b = at 9 and 10 terminals one "dry" contact NO output (NO → NC, when the "No-touch" sensor is activated by hand)
- a b c [] Jumper between b and c = at 9 and 10 terminals one "dry" contact NC output (NC → NO when the "No-touch" sensor is activated by hand)

LOWER SCREW TYPE TERMINAL BOX

- 6 = (+) buzzer control input
- 7 = power inlet (+) 12 Vdc
- 8 = power inlet (-) " "
- 9 = 1st pole for NO or NC output contact (see jumper setting)
- 10 = 2nd pole " " " " " "

